

Pioneer

Installation Manual
Double DIN Kit

dark-grey: CA-HM-KIA 001 DG
light-grey: CA-HM-KIA 001 LG
silver-grey: CA-HM-KIA 001 SG

Kia Sportage III 2010->

Compatible with these double DIN devices

Pioneer Navigation

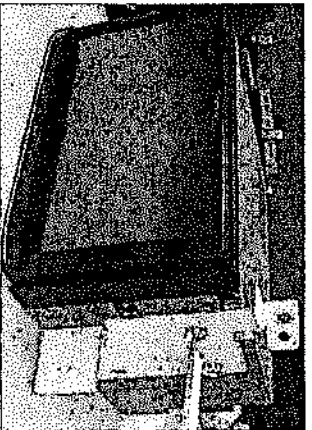

9. Attach metal mounting brackets to Double DIN Navigation

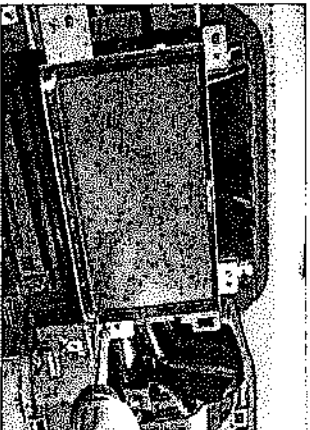

10. Connect all required circuit points
Fix Double DIN Navigation on dashboard

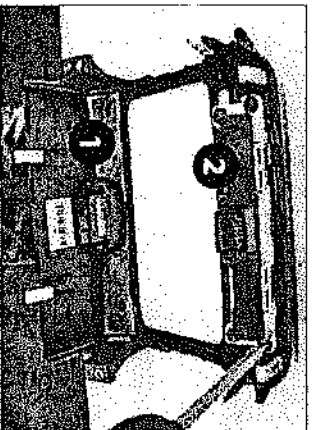

11. Remove hazard light switch (1) from OEM head unit - attach it to double DIN fascia plate
Remove upper instrumental panel (2) - attach it to double DIN fascia plate

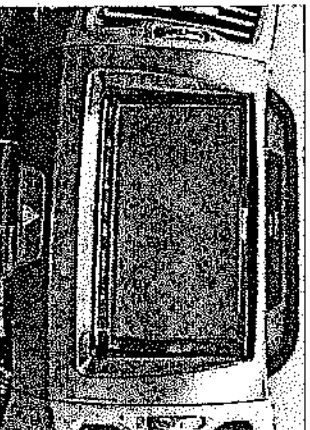

- Fix clips to double DIN fascia plate
Place double DIN fascia plate
Reinstall everything in reverse order to finish installation

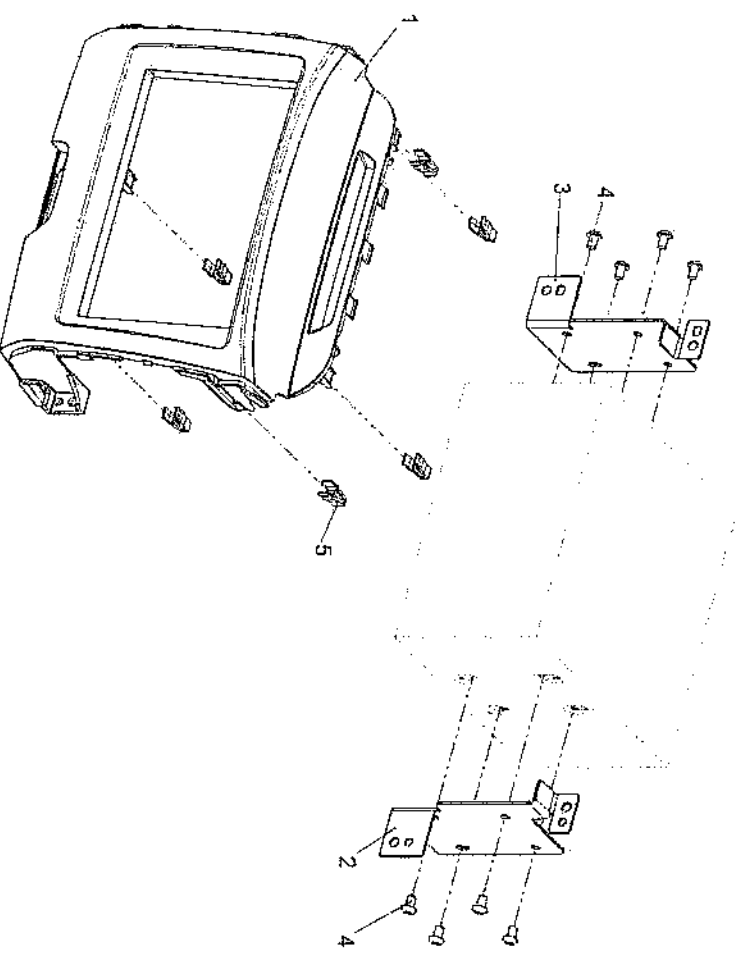

(1) Double DIN Facia Plate
(2) Mounting bracket (right)

(3) Mounting bracket (left)
(4) Fixing screws
(5) Clips



1. Remove screws of OEM head unit (left and right)

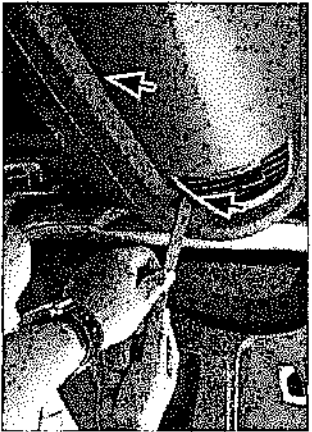

2. Unclip right side panel

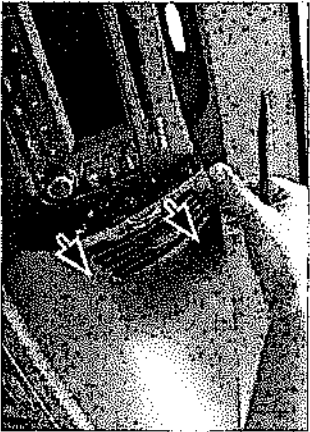

3. Remove right side panel by pulling it towards your direction



4. Undlip left side panel

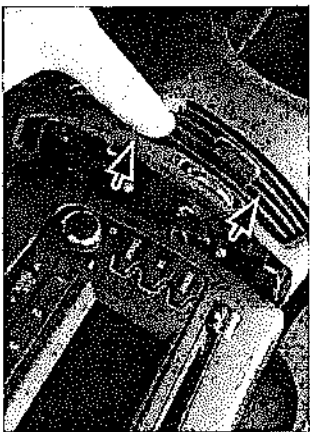

5. Remove left side panel by pulling it towards your direction



6. Remove screws of OEM head unit
Remove OEM head unit

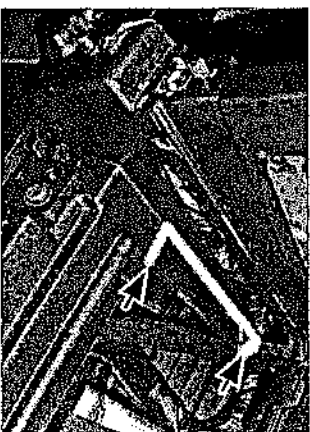

7. Cut here: see white line (left side)

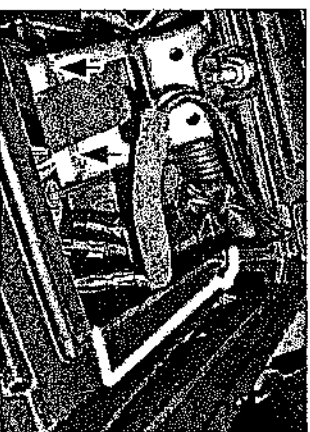

8. Cut here: see white line (right side)
Bend down metal bar (see arrows) in order to clear space for double DIN head unit