

**APPLICATIONS
TOYOTA PRIUS
2010**

CA-HM-TOY.001

KIT FEATURES

- DDIN Head Unit Provision
- Stacked ISO DIN Head Unit Provision
- Painted Scratch Resistant Matte Black



KIT COMPONENTS

- A) DDIN Radio Housing
- B) DDIN Brackets
- C) Radio Housing Trim Panel
- D) Trim Plate

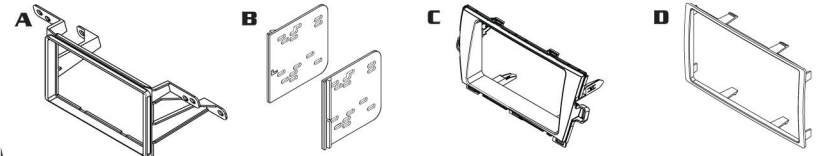

WIRING & ANTENNA CONNECTIONS (SOLD SEPARATELY)

- 70-1761 Toyota Harness 1987-UP
- TYTO-01 Toyota Prem Sound Interface

TOOLS REQUIRED

- Phillips Screwdriver
- Panel Removal Tool
- Socket Wrench



NOTES

2010 TOYOTA PRIUS

- 1** Disconnect the negative battery terminal to prevent an accidental short circuit.
- 2** Unsnap and remove the shifter trim. (Fig. A)
- 3** Unsnap and remove the console panel (extends from the pocket up the passenger side to the upper vents). (Fig. B)
- 4** Unsnap the ignition button trim panel (not necessary to remove). (Fig. C)
- 5** Unsnap and remove the radio/ climate trim panel. (Fig. C)
- 6** Remove four ten mm bolts to remove the radio.

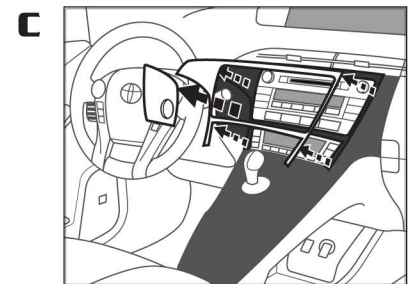
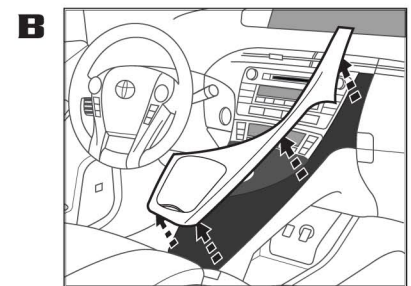
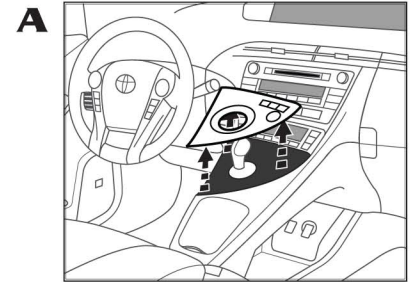

Continue to Kit Assembly

2010 TOYOTA PRIUS DDIN / STACKED ISO DIN HEAD UNIT PROVISION

1 Attach the Double DIN brackets to the Double DIN housing. (Fig. A)

A

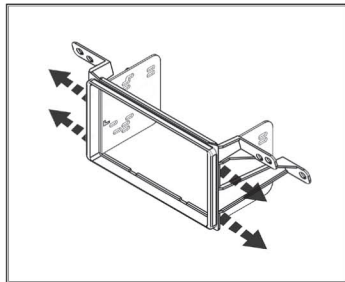

2 Slide the Double DIN head unit or stacked ISO head units into the bracket/radio housing assembly and secure the Double DIN head unit or stacked ISO head units to the assembly using the screws supplied with the radio. (Fig. B)

B

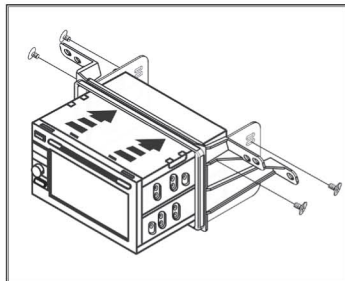

3 Snap the Trim plate into the Radio Housing.

4 Locate the factory wiring harness in the dash and connect relevant harness adapters.

5 Mount the Radio Housing/ radio into the dash, snap the Radio Housing Trim Panel over that, and reassemble the dash.

NOTES
