

This guide is intended to guide you through the basic functions of this navigation system. For details, please refer to Operation Manual.

## Basic hardware buttons



- ① **▲ button**  
Press to display the touch panel keys for ejecting the media.
- ② **VOL (+/-) button**  
Press to adjust the AV (Audio and Video) source volume.
- ③ **HOME button**  
Press to display the "Top Menu" screen.
- ④ **MODE button**  
Press to switch between the map screen and the AV operation screen.
- ⑤ **TRK (◀◀/▶▶) button**
- ⑥ **Ⓜ button**  
Press briefly to hear the current route guidance.  
Press and hold to mute the AV source.

## Screen switching overview

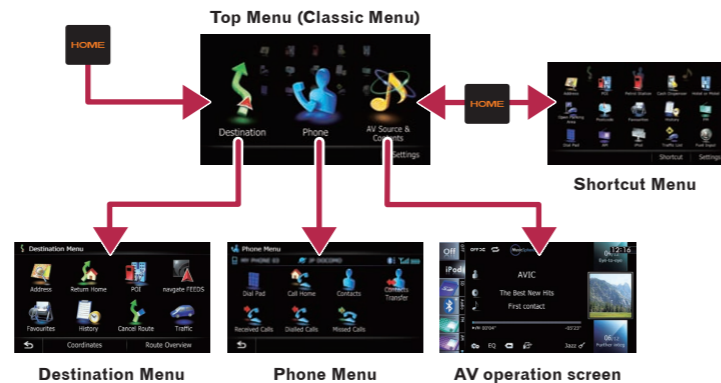

## Basic items on the map



- ① Name of the street to be used (or next guidance point)
- ② Current time
- ③ Estimated time of arrival (default)
- ④ Current route
- ⑤ Current position
- ⑥ Street name that your vehicle is travelling along
- ⑦ Eco-Meter
- ⑧ Map control
- ⑨ Next direction of travel

## Destination Menu

Touch **Destination** on the "Top Menu" screen.

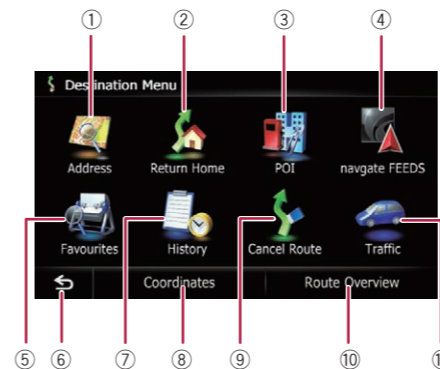

- ① Searches for a location by address
- ② Calculates the route to your home
- ③ Searches for a place such as stores, restaurants, and other facilities (Points Of Interest – POI) in the database
- ④ Searches for POIs by using the data on the microSD card
- ⑤ Stores and selects your favourite locations
- ⑥ Returns to the previous screen
- ⑦ Selects a previously routed destination
- ⑧ Searches for a location by coordinates
- ⑨ Cancels your current route guidance
- ⑩ Displays the current route information
- ⑪ Displays traffic information

## Searching for your destination by address

- 1 Display the "Destination Menu" screen and touch **Address**.

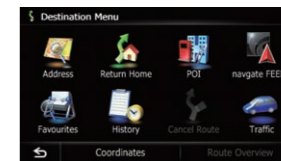

- 2 Select the country you desire.

- 3 Input the information that you want to set as the destination.

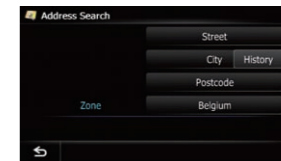

Touch one of the options. After narrowing down your destination, the Location confirmation screen will appear.

- 4 Touch **OK**.



After searching for the destination, the Route confirmation screen appears.

- 5 Touch **OK**.



The navigation system gives you route guidance both visually and by voice.

## Setting route guidance volume

- 1 Touch the keys in the following order on the “**Top Menu**” screen.  
Settings → System Settings → Volume

- 2 Touch **+** or **-** to change the volume of the route guidance.

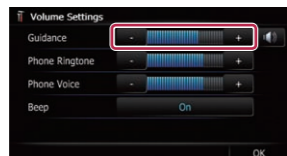

## Inserting and ejecting a microSD card

For details about playable files, refer to Operation Manual.

### Inserting a microSD card

- 1 Insert your microSD card into the SD card slot until it clicks.

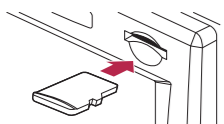

### Ejecting a microSD card

- 1 Press the **▲** button.
- 2 Touch **Eject SD**.
- 3 Press the middle of the microSD card gently until it clicks.
- 4 Pull the microSD card out straight.

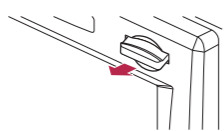

## Using the radio (FM)

Scroll the screen by dragging an AV source icon up or down, and tap **FM** on the AV operation screen.

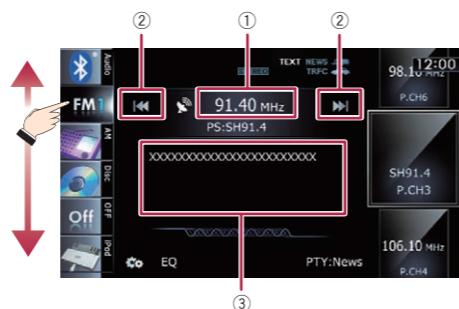

- 1 Displays the current preset frequency
- 2 Scans frequencies until a broadcast strong enough for good reception is found by touching and holding (seek tuning)
- 3 Displays the detailed radio text currently received

## Playing your Apple iPod

You can control an iPod by connecting the USB interface cable for iPod (CD-IU51V) (sold separately) to the navigation system.

- 1 Connect your iPod.

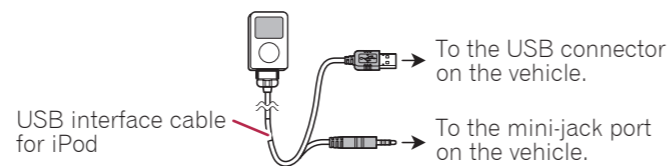

The source changes and then playback will start.

- 2 Tap or drag the key that you want to operate.

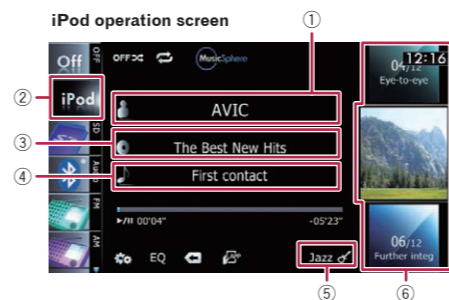

### List screen (e.g. song list)



- 1 Displays the artist name list
- 2 Displays the category list
- 3 Displays the album title list
- 4 Displays the song title list
- 5 Displays the genre list
- 6 Selects the song to play by scrolling the keys up or down. To play the song, tap it
- 7 Switches the list screen between music and video
- 8 Returns to the iPod operation screen
- 9 Starts playback by tapping an item to select
- 10 Selects a song by scrolling the character tab up or down. Tap the tab of the character for the song title that you want to display

## Pairing your phone

- 1 Activate the Bluetooth® function on your phone.
- 2 Touch the keys in the following order on the “**Top Menu**” screen.  
Settings → Bluetooth Settings

- 3 Touch **Bluetooth On/Off** to select **On**.



- 4 Touch **Registration** on the “**Bluetooth Settings**” screen.

The system searches for and lists nearby devices.

- 5 Touch your phone on the list.

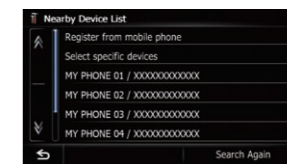

- 6 Enter the PIN code from your phone. (The default code is 1111.)

When pairing succeeds, a message will appear.

## Transferring the phone book

- 1 Connect the mobile phone.
- 2 Touch **Contacts Transfer** on the “**Phone Menu**” screen.
- 3 Check that the following screen is displayed, and operate your mobile phone to transfer the phone book entries.

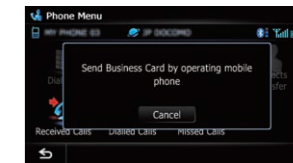

When data transfer is finished, a message asking whether you want to transfer more data appears.

- 4 Touch **No**.

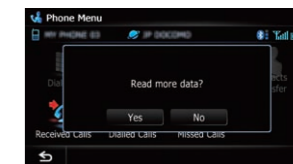

The transferred data is imported to the navigation system.