

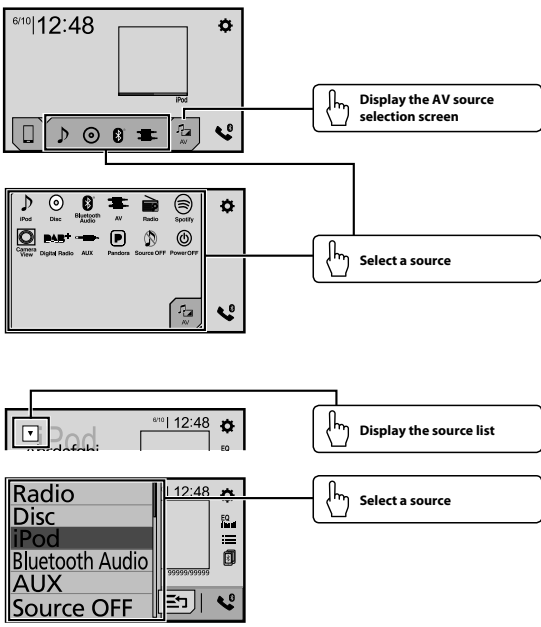

### Selecting the source

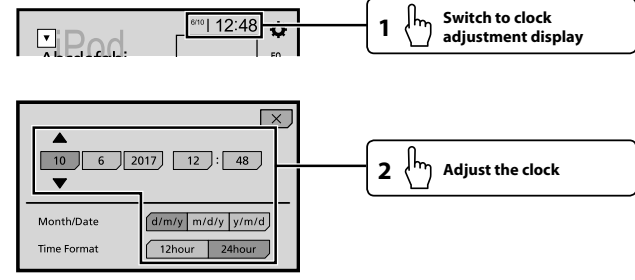

### Setting the clock



### Tuner operation

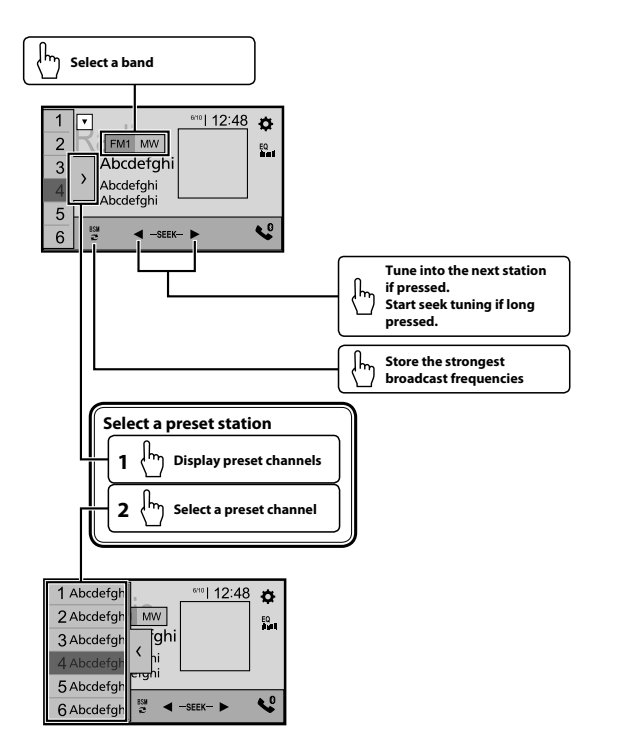

### Moving images operation

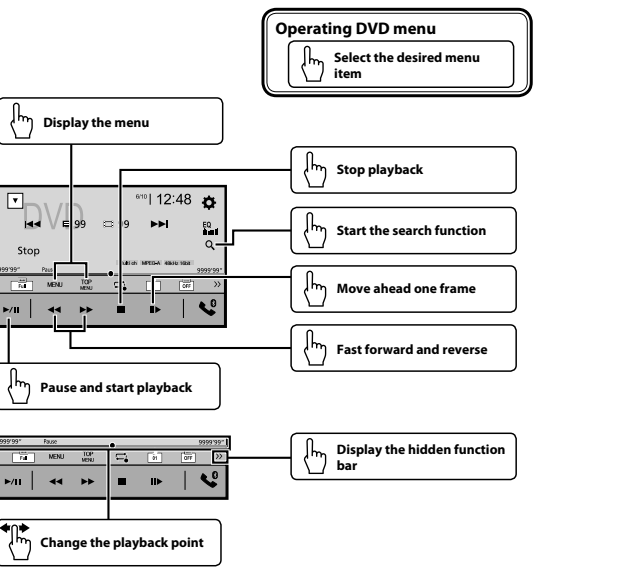

### Moving images operation

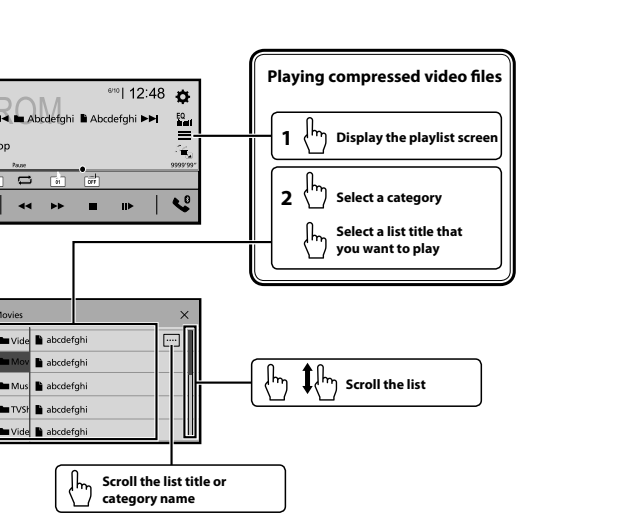

### Audio operation

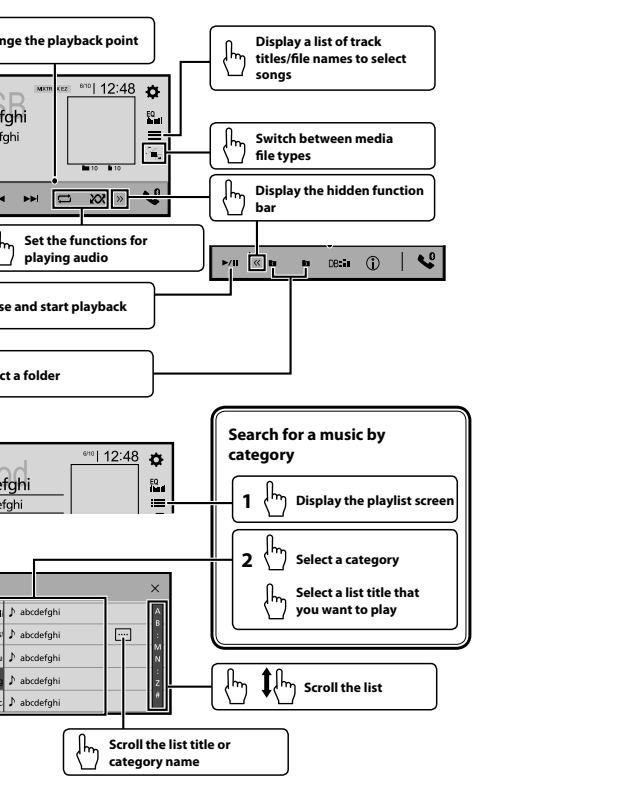

### Bluetooth telephone operation

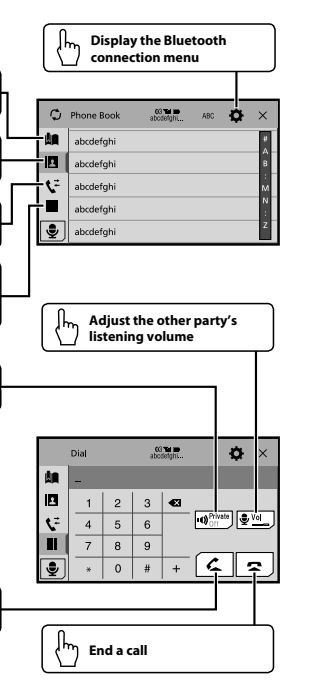

### What's What

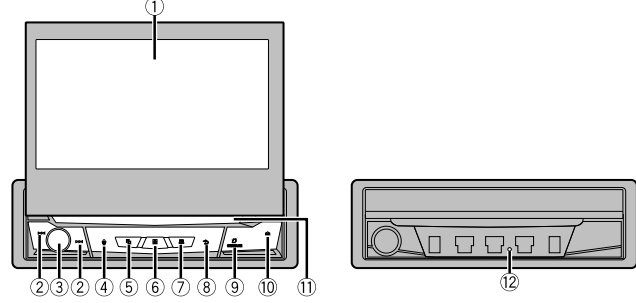

- 1 LCD screen
- 2 <<>>>> buttons  
Press to return to the previous track (chapter) or go to the next track (chapter). Press and hold to perform fast reverse or fast forward. Press to answer or end a call.
- 3 Volume/SRC/OFF  
Press to cycle through all the available sources. Press and hold to turn the source off.
- 4 <img alt="voice icon" data-bbox="885 555 895 575"/> button  
Press to activate the voice recognition mode such as Siri when iPhone is connected to the unit via Bluetooth or USB.
- 5 <img alt="camera icon" data-bbox="885 605 895 625"/> button  
Press to switch between the Application screen and the AV operation screen. Press and hold to switch to the camera view mode.
- 6 <img alt="grid icon" data-bbox="885 655 895 675"/> button  
Press to display the top menu screen. Press and hold to power off.
- 7 <img alt="list icon" data-bbox="885 705 895 725"/> button  
Press to display the menu bar. Press and hold to mute or unmute.
- 8 <img alt="back icon" data-bbox="885 755 895 775"/> button  
Press to display the top menu screen or back to previous screen. Press and hold to turn off the display.  
<img alt="square icon" data-bbox="885 805 895 825"/> When the display is turned off, touch the screen to revert to the original screen.
- 9 OPEN/CLOSE button  
Press to open the LCD panel. To close the LCD panel, press again.
- 10 <img alt="up arrow icon" data-bbox="885 855 895 875"/> button
- 11 Disc-loading slot
- 12 RESET button







### Wahl der Signalquelle

: Antippen : Antippen und schieben

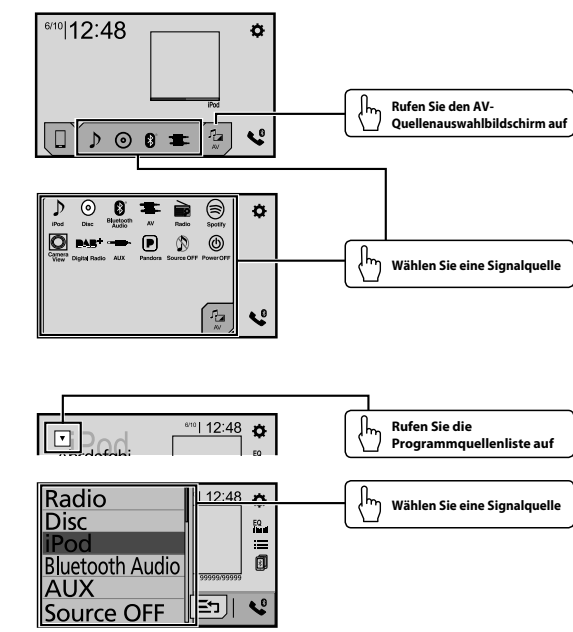

### Einstellen der Uhrzeit

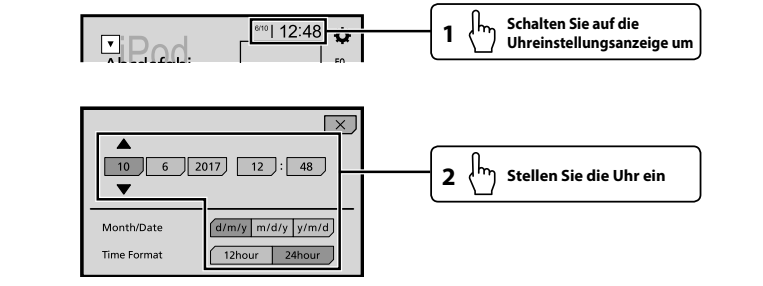

### Tuner-Betrieb

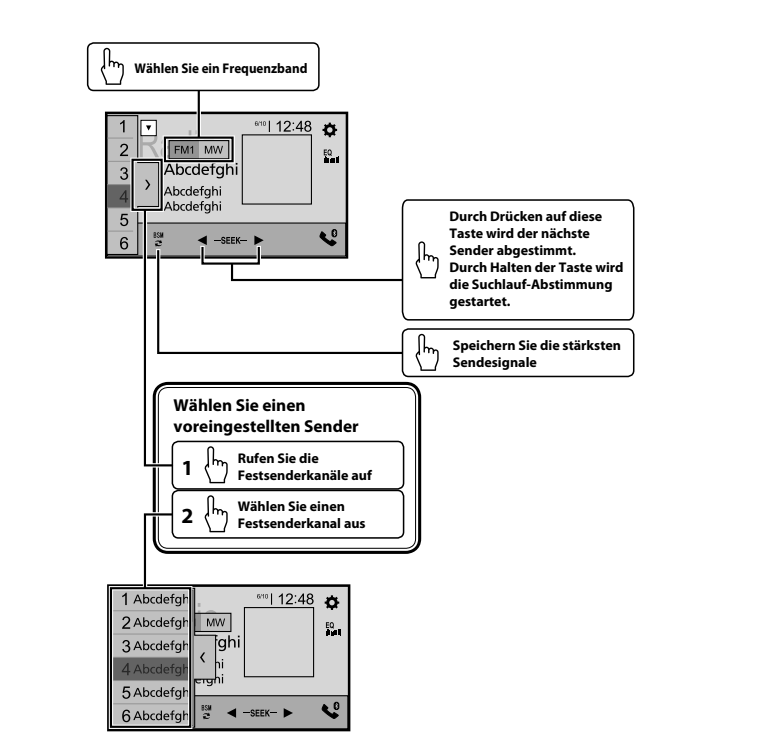

### Bewegbild-Betrieb

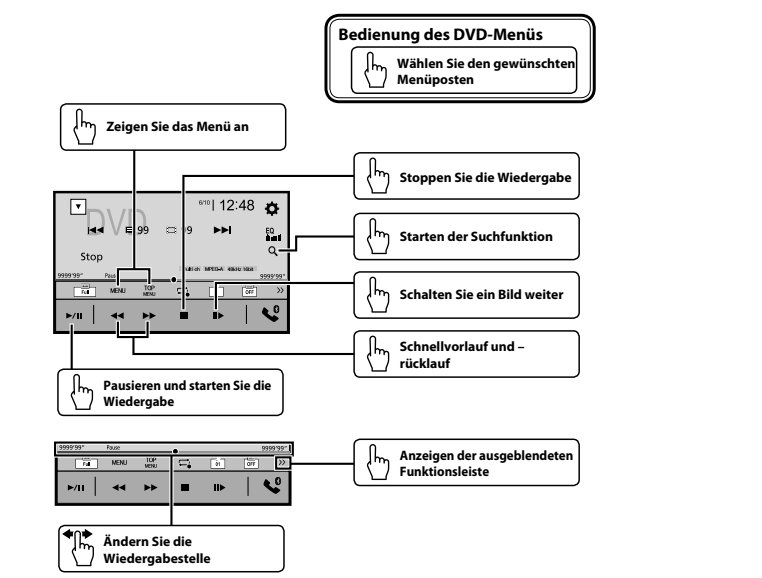

### Bewegbild-Betrieb

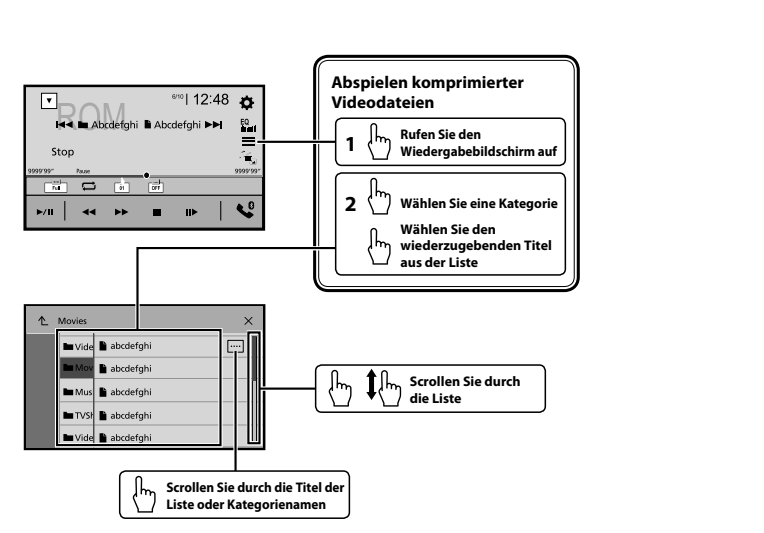

### Audio-Betrieb

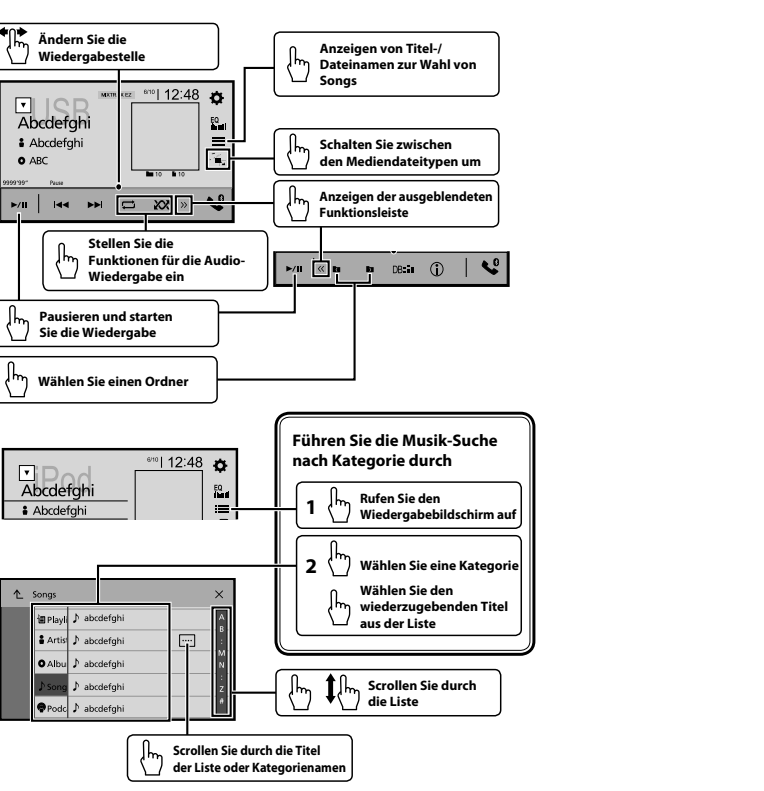

### Bluetooth-Telefonbetrieb

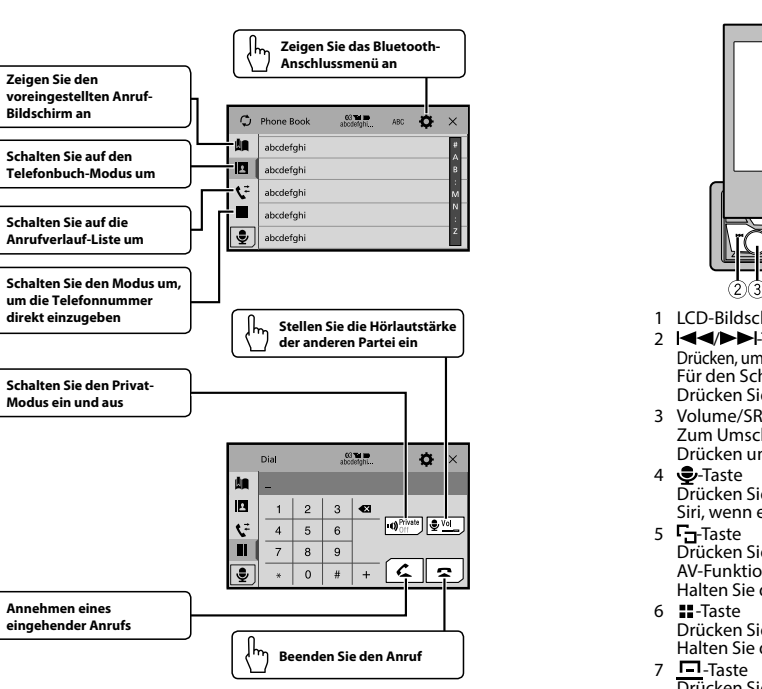

### Die einzelnen Teile

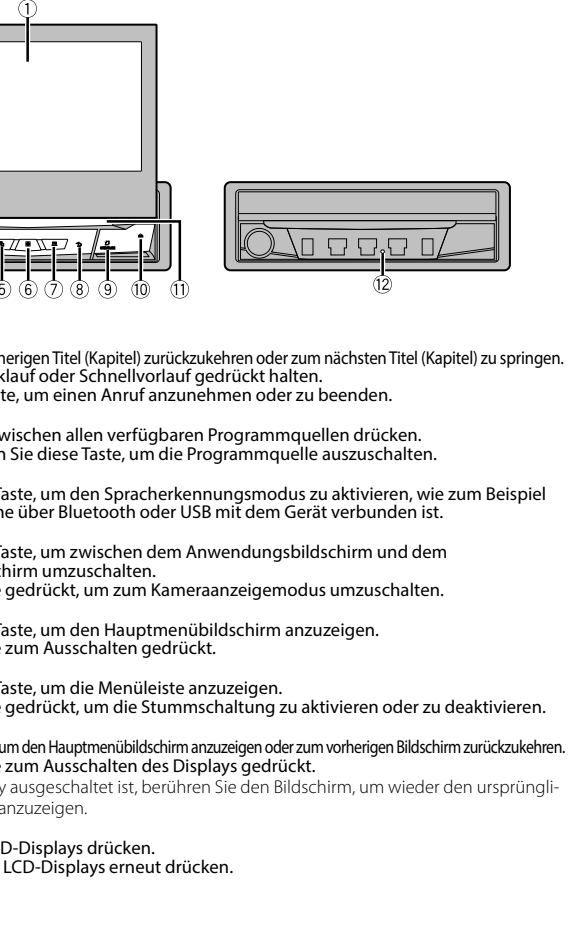

### Selecteren van de signaalbron

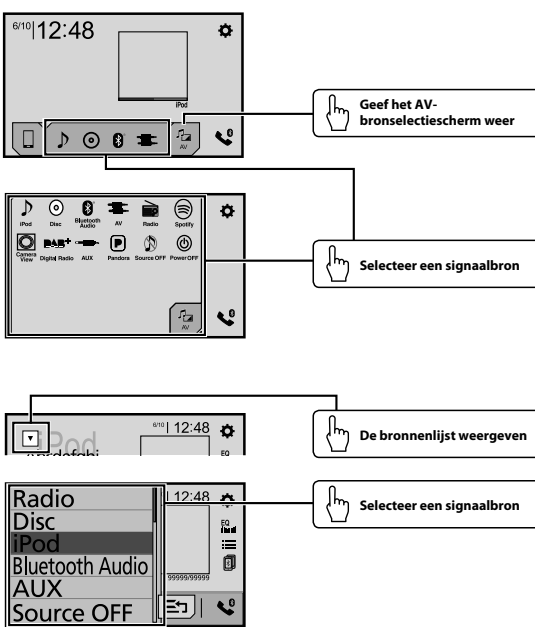

### De klok instellen

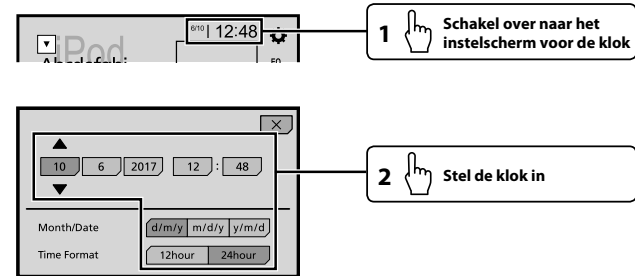

### Bediening van de tuner (radio)

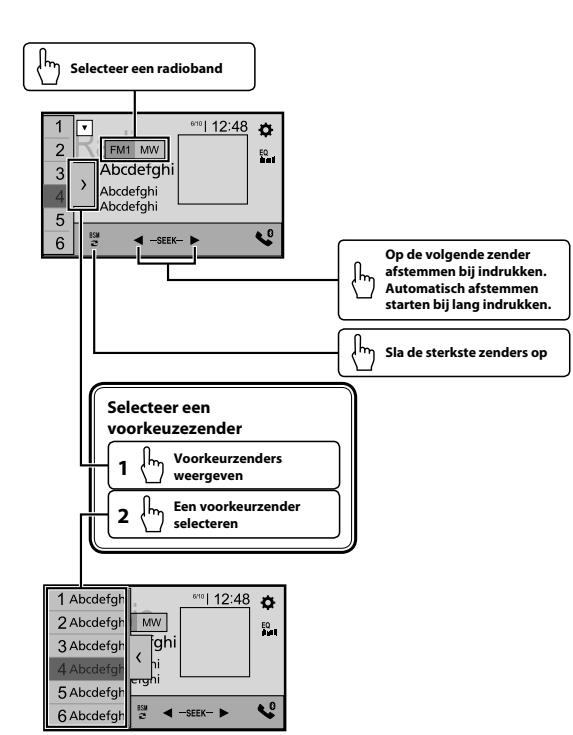

### Bediening bewegende beelden

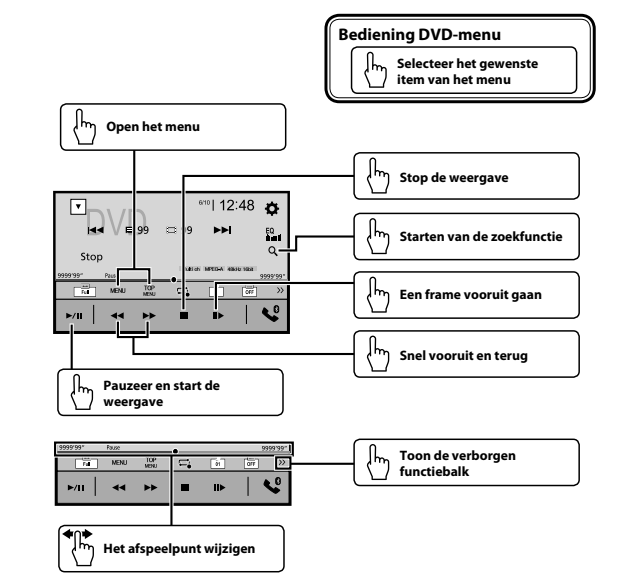

### Bediening bewegende beelden

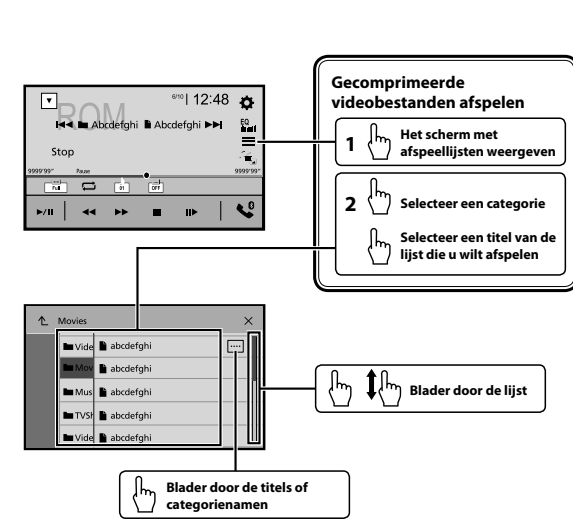

### Bediening audiofuncties

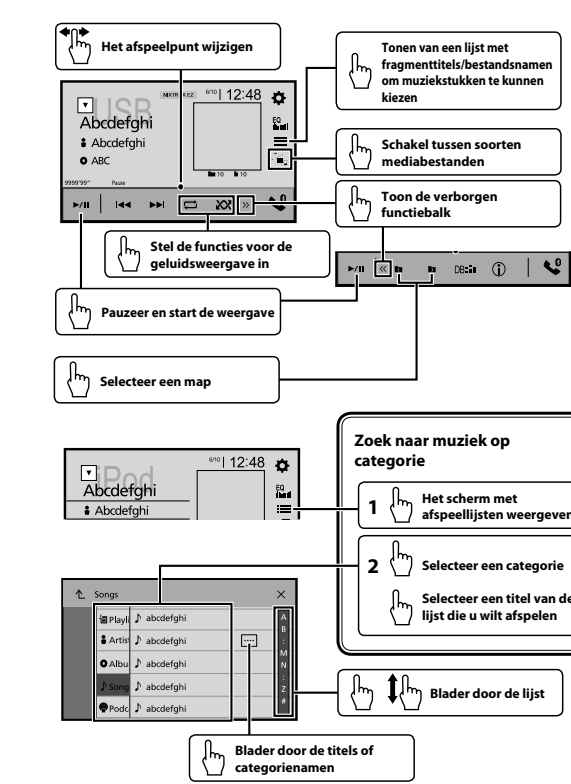

### Bediening Bluetooth telefoon

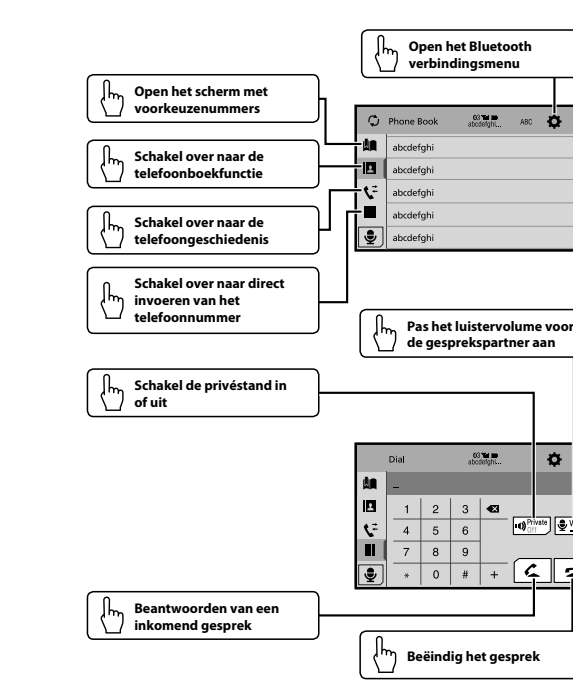

### Wat is wat

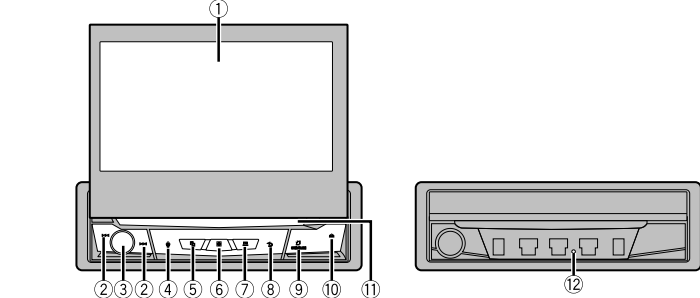

- 1 LCD-scherm
- 2 < << >> > >> -toetsen  
Druk op deze toets om terug te gaan naar het vorige nummer (hoofdstuk) of het volgende nummer (hoofdstuk).  
Houd deze toets ingedrukt om snel achteruit of vooruit te spelen.  
Druk hierop om een oproep te beantwoorden of te beëindigen.
- 3 Volume/SRC/OFF  
Druk hierop om te bladeren door alle beschikbare bronnen.  
Houd deze toets ingedrukt om de bron uit te schakelen.
- 4 <-toets  
Druk hierop om de spraakherkenning te activeren, zoals Siri wanneer een iPhone via Bluetooth of USB is aangesloten op het apparaat.
- 5 <-toets  
Druk hierop om over te schakelen tussen het applicatiescherm en het AV-bedieningsscherm.  
Houd ingedrukt om over te schakelen naar de cameraweergavemodus.
- 6 <-toets  
Druk hierop om het beginmenuscherm weer te geven.  
Houd ingedrukt om het apparaat uit te schakelen.
- 7 <-toets  
Druk hierop om de menubalk weer te geven.  
Houd ingedrukt om het geluid te dempen of weer te geven.
- 8 <-toets  
Druk hierop om het hoofdmenu weer te geven of om naar het vorige scherm terug te keren.  
Houd ingedrukt om het display uit te schakelen.  
□ Wanneer het display is uitgeschakeld, tikt u het scherm aan om terug te keren naar het originele scherm.
- 9 OPEN/CLOSE-toets  
Druk hierop om het LCD-paneel te openen.  
Druk hier opnieuw op om het LCD-paneel te sluiten.
- 10 <-toets
- 11 Disc-laadsleuf
- 12 RESET-toets

